



COMFORT – a helping hand
for an active life



COMFORT

Making the most of life

Very few people are happy to see restrictions being placed on their active lives. However, we cannot ignore the facts of life, and we have to accept that the passage of time is beyond our control. When we are not as young as we used to be, and we are no longer able to do everything we would like, then we might find ourselves in need of a helping hand.

Modern and well-designed bathroom furniture can help to make life easier when washing and going to the toilet. However, it also needs to match the rest of your interior design. Ideally, it ought to be such a natural part of a tastefully designed bathroom that neither you nor your visitors give it a thought. So you just use the furniture and enjoy the fact it's there.

The COMFORT series offers you a helping hand and aesthetically pleasing design.

keep living



Contents

The art of contemplation	Page 4
The art of sitting comfortably	Page 8
The art of finding solitude	Page 12
Washing	Page 16
Going to the toilet	Page 24
Taking a shower	Page 28
Taking a shower – in the small bathroom.	Page 30
Installation and mounting.	Page 32
Method of testing	Page 34

The art of contemplation

Have you ever considered how many things take place at the wash basin? There are all the obvious activities: Brushing your teeth, shaving, doing your make-up and so on. But also just being able to stand there, contemplating things every so often. To study the face that which has always been

yours. Having a bit of time to yourself. The wash basin is where we often pause for a while and let our thoughts roam free. There has to be time for this, both for you and for everyone else who uses the wash basin.







The COMFORT series comprises the wash basin and all the accessories that make it possible for you and others to use the wash basin each day. If something is worth doing, it's worth doing well. It goes without saying that functionality, design and safety must be top-notch. If you need to be able to use the wash basin when standing or sitting down, the basin can be mounted on a height-adjustable bracket. Adjustment is effected via a simple arm which is designed to blend perfectly with any exclusive bathroom environment.



The taps feature ergonomic handles that make it easy to turn the water on and off, even for those who have difficulty operating ordinary taps. The COMFORT series also includes baskets and modular shelves. All designed and conceived so that you and your guests fully enjoy the time you spend in the bathroom.





The art of sitting comfortably

In truth, we spend quite a lot of time out here – on the toilet. There is no reason to hide the fact. Also, there is no reason to pretend that we don't need a little help when using the toilet.

It stands to reason that we want to be comfortable when we have to sit on it anyway. At the same time, it might as well look good, as you are not the only one who uses it from time to time.







The COMFORT series gives you peace of mind when going to the toilet, aiding the process of sitting down and getting up. It also ensures that you sit comfortably on the toilet as well as offering more advanced assistive functions. Perhaps you would like to be able to flush the toilet without having to twist and turn your body? In which case, you can elect to have flush buttons mounted on the support arm – right by your hand.

This is a series of exclusively designed products that provide the extra help you need to make your visits to the bathroom each day a pleasing experience. Pleasing for your body – especially to the eye.





The art of finding solitude

It's morning, and a new day is dawning. Your day begins in the bathroom, and spending a quiet moment on your own is a pleasant way to start the day. The COMFORT series helps you to overcome the challenges you face when you take a shower

each day. In an inviting environment, fitted with stylish and functional shower seats and handrails, you have the support and sense of security you need.







You start the day surrounded by well-designed and innovative bathroom furniture that provides the assistance you require. COMFORT bathroom furniture for the shower matches your bathroom elegantly and effortlessly.

It is vital that the best furniture for the shower can be integrated with your existing bathroom environment, in addition to which it must be functional, hard-wearing and, most importantly, beautifully designed. The basic idea behind the COMFORT series is that you experience two things: The pleasure that comes from having a comfortable and tastefully designed product. The pleasure that comes from having the support you need just when you need it.

Sometimes you may feel the need to rest your legs, even in the bathroom. If space is limited, you can probably find a suitable solution in the COMFORT series. Folding seats and small shower seats fit in easily when there is no room for other bathroom furniture. You can choose from a range of seats that are height adjustable or mounted at a fixed height. All seats are comfortable and discrete, taking up virtually no space when not in use.

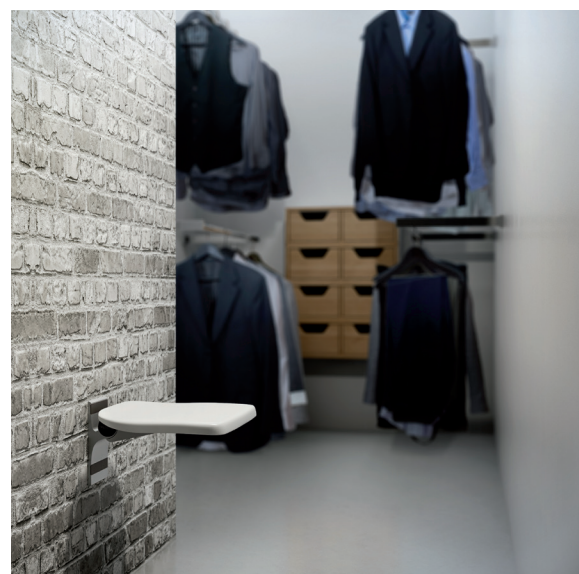
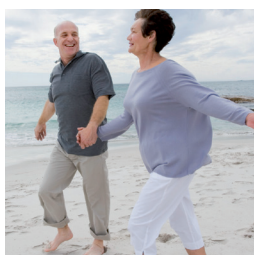

Washing



MATRIX Small

- ◀ **R2020000** Wash basin with handrails and overflow
- R2021000** Wash basin with handrails, without overflow

MATRIX Small is a narrow wash basin with two integrated handrails in the front.

Material: Crushed marble with a high-gloss, non- porous sanitation coating



MATRIX Large

- ◀ **R2030000** Vanity wash basin with handrails and overflow
- R2031000** Vanity wash basin with handrails, without overflow

MATRIX Large is a vanity wash basin designed for bathrooms with plenty of space.

Material: Crushed marble with a high-gloss, non- porous sanitation coating



MATRIX New Curve

- ◀ **R2052000** Wash basin with overflow
- R2053000** Wash basin without overflow

The concave front edge stabilises standing as well as seated users.

Material: Ceramics

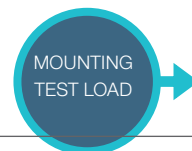

P. 32-35

The wash basin has a flat bottom, leaving room for the user's legs underneath. It is ideal for bathroom swwhere the available space has to be efficiently utilised.

The wash basin has raised edges, preventing water from running over the back or sides of the wash basin.

Tap hole: Ø 36 mm

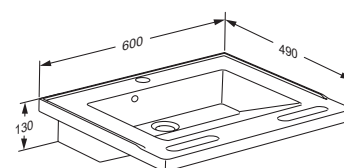

The wash basin has two integrated handrails on the front edge and two handrails at the sides.

The wash basin has a flat bottom, allowing wheelchair users to manoeuvre right underneath. The wash basin has raised edges, preventing water from running over the back or sides of the wash basin.

Tap hole: Ø 36 mm

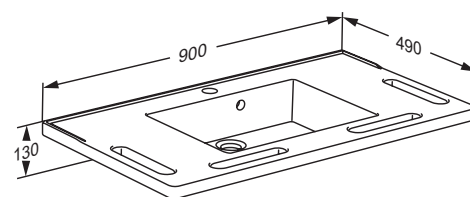

The wash basin slopes down to the front, offering ergonomically correct support for the elbows, while the flat bottom allows room for the user's legs underneath the wash basin.

Tap hole: Ø 36 mm

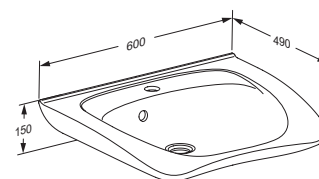

Washing



Mixer tap, sensor-operated

RT631 Tap with sensor

The tap with sensor is simple to install as it is battery powered (6 Volt). The battery has a life of 4-5 years. Infrared sensor technology makes the tap very user-friendly. The water temperature is set on the side of the faucet.

Material: Chromium-plated brass



Wash basin taps

RT622 Tap, long rotatable spout

The ring-shaped operating lever is suitable for disabled users. The long rotatable spout makes it easier for seated users to reach the water and the spout can always be pushed to one side, if it is in the way.

Material: Chromium-plated brass



Mixer tap, TMV3-rated

RT623 TMV3 Anti-scald water tap

TMV3 tap featuring anti scald technology, a safe touch body and a self draining spout.

Material: Chromium-plated brass

A tap with sensor helps improve hygiene, as it is not necessary to touch the tap in order to turn on the water. The risk of transferring bacteria is thereby reduced.

VA-approved (Denmark)

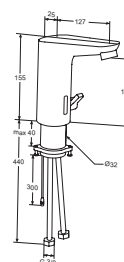

Scald protection prevents unintended water temperatures above 40°C. Integrated water-saving function for high and low flow rates. The lever is spring-loaded, which prevents splashing and unintentional excessive use of water. The small and large water flow rates can be adjusted.

VA-approved (Denmark).

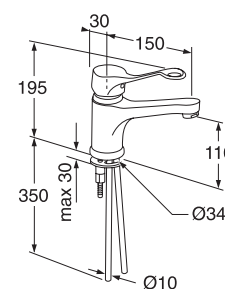

A TMV3 thermostatic mixer valve can respond quickly by turning off the water if the cold water fails to appear, or the temperature rises above the set maximum temperature

TMV3-rated (United Kingdom).

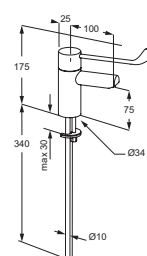

Washing



PLUS High-adjustable wash basin bracket

- R4752** Electrically operated wash basin bracket with cordless remote control
- R4751** Electrically operated wash basin bracket with wired hand control
- R4750** Electrically operated wash basin bracket with lever control
- ◀ **R4650** Gas-assisted wash basin bracket with lever control

Materials: Aluminium, plastic.
Test load: 100 kg incl. wash basin.

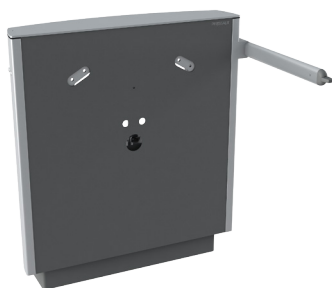

SELECT High-adjustable wash basin lifter

- ◀ **R4950000** 300 mm height adjustable with electric motor and lever control (white)
- R4950112** 300 mm height adjustable with electric motor and lever control (anthracite grey)
- R4951000** 300 mm height adjustable with electric motor and wired hand control (white)
- R4951112** 300 mm height adjustable with electric motor and wired hand control (anthracite grey)

Materials: Cover plater: Plastic PS, Side and top plates: Aluminium
Test load: 150 kg incl wash basin



MATRIX wash basin brackets

- ◀ **R2015** Manually adjustable wash basin brackets, set of 2 pcs.
- R2010** Fixed wash basin brackets, set of 2 pcs.

Wash basin brackets for MATRIX Large and MATRIX Angle

Materials: Powder coated stainless steel
Test load: 150 kg incl. wash basin



Installation covers

- R2056** Suitable for wash basin R2052 and R2053
- R2057** Suitable for wash basin R2020 and R2021

Materials: Plastic

MOUNTING
TEST LOAD

P. 32-35

With the wash basin bracket mounted at the recommended height, the height of the wash basin can be adjusted by 300 mm from 668 mm to 968 mm above floor level.

R4650 is supplied with a gas cylinder for wash basins weighing 16 - 22 kg as standard. However, it is possible to order R4650 with cylinders for wash basins weighing 8 - 12 kg and 12 - 16 kg.

Its rounded, sleek design makes cleaning easy. The wash basin bracket suits all types of bolt-mounted washbasin.

Height-adjustable wash basin brackets require a flexible feed and waste system, R2061 (R2071 for UK market). For placement of plumbing and electrical installations, see page 29.

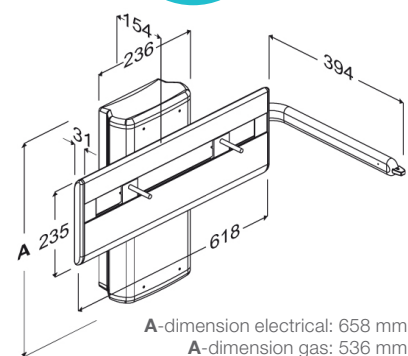

The height of the wash basin can be adjusted 300 mm, from 670 to 970 mm above the floor, simply using the user-friendly lever control at the end of the wash basin or the wired remote control.

The lever control can be positioned on either side of the wash basin and also serves as a towel holder. The lever control is strong enough to be used as an extra support.

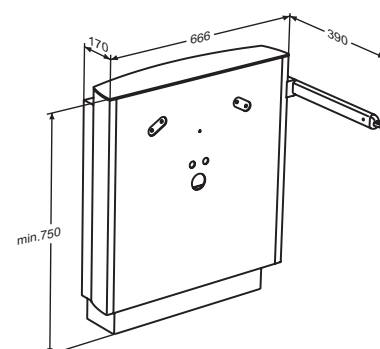

If the supports are mounted at the recommended height, the wash basin can be adjusted 200 mm, from 700 to 900 mm above the floor.

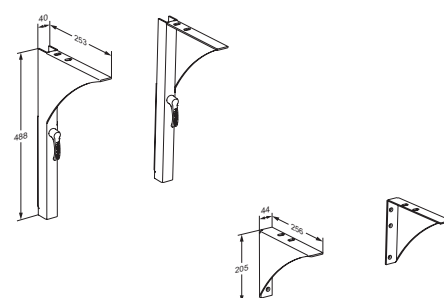

Installation cover, recommended for SELECT wash basin lifter to cover and protect the waste system.

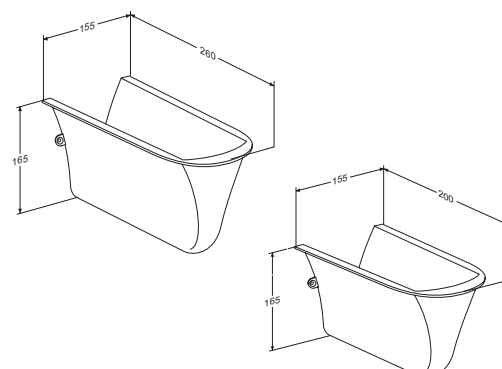

Washing



Modular shelves

- RT481** 600 mm rod, 2 shelves, towel holder, 2 trays
- ◀ **RT480** 400 mm rod, 1 shelf, towel holder, 1 tray

The shelf module is suitable for mounting on wash basin brackets and will therefore follow the wash basin's movements up and down.

Materials: Aluminium, plastic laminate, stainless steel, plastic
Test load: 4 kg



Mirror fittings and towel hooks

- RT924** Mirror incl. 4 mirror fittings
- RT943** Hooks, 2 pcs



Handrails

- RT102000** 600 mm (white)
- ◀ **RT102112** 600 mm (anthracite grey)
- RT103000** 800 mm (white)
- RT103112** 800 mm (anthracite grey)
- RT104000** 1000 mm (white)
- RT104112** 1000 mm (anthracite grey)

Materials: Powder-coated aluminium, plastic
Test load: With spans up to 1000 mm: 210 kg

Everything within easy reach. The practical modular shelves are mounted directly onto the wash basin bracket so the hand soap, the hand towel, the toothbrush and whatever else you need are all within easy reach.

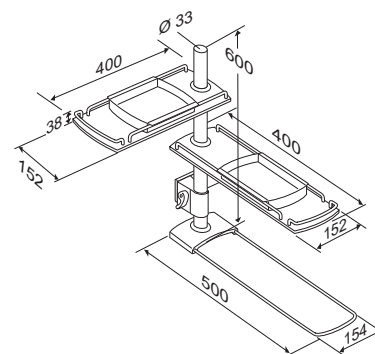

Mirror fittings and towel hooks in a sleek and minimalist design.

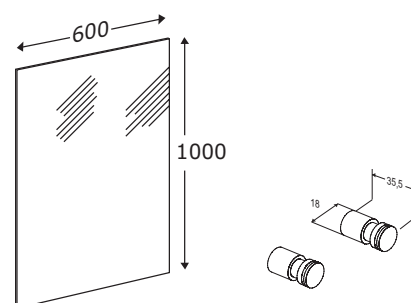

A handrail mounted by the wash basin provides support, a sense of security and increased independence. They can be placed either horizontally or vertically. The handrails are supplied in white or anthracite grey.

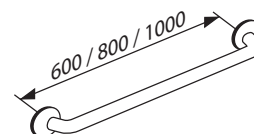

Going to the toilet

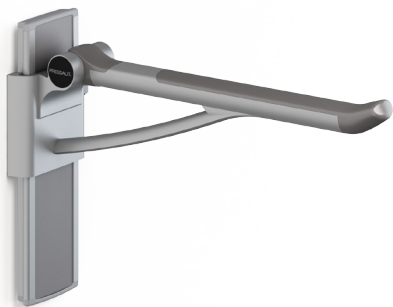

Height-adjustable support arms

- R3160112000** Support arms, length 600 mm (white)
- ◀ **R3160112112** Support arms, length 600 mm (anthracite grey)

With the vertical wall track mounted at the recommended height, the height of the support arm can be adjusted by 240 mm from 645 to 885 mm above floor level.

Materials: Aluminium, plastic, two-component plastic
Test load: 150 kg

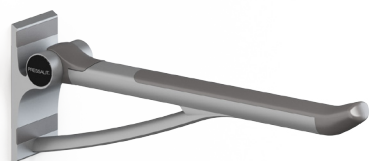

Fixed support arms

- R3060000** Support arm, length 600 mm (white)
- ◀ **R3060112** Support arm, length 600 mm (anthracite grey)
- R3070000** Support arm, length 700 mm (white)
- R3070000** Support arm, length 700 mm (anthracite grey)

The wall bracket is mounted at the desired height to meet the needs of the individual user.

Materials: Aluminium, plastic, two-component plastic
Test load: 150 kg



Toilet seats

- ◀ **R37000** Dania with cover and hinges
- R38000** Dania with cover, open front, with hinges

Materials: Thermoset plastic, stainless steel
Test load: 250 kg



Toilet seat, 50 mm raised

- R33000** Dania, 50 mm, with cover
Supplied with special hinges.

Materials: Thermoset plastic, stainless steel
Test load: 150 kg

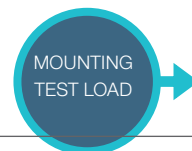

P. 32-35

Height adjustment makes it possible to raise or lower the support arms to provide the greatest possible support and comfort for the individual user.

Folding support arms create more space in the room by folding away when not in use.

The end of the support arm offers good support when sitting down or getting up. It is also designed so the user will recognise by feel where the support arm ends.

The non-slip surface ensures a firm yet comfortable grip.

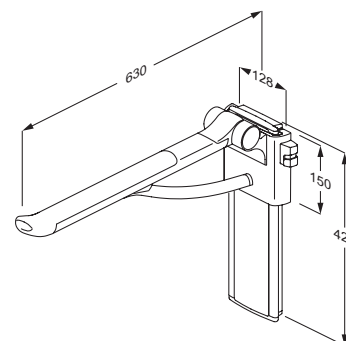

Folding support arms create more space in the room by folding away when not in use.

The end of the support arm offers good support when sitting down or getting up. It is also designed so the user will recognise by feel where the support arm ends.

The non-slip surface ensures a firm yet comfortable grip.

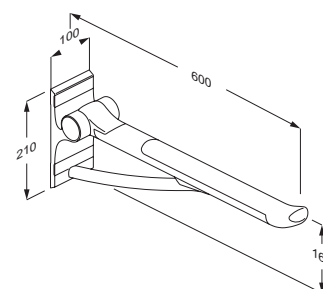

Dania is an anatomically well-designed seat, which is suitable for most people. The cover is comfortable to sit on and, when raised, provides good back support.

Supplied with universal hinges B82/B83. Also available with hinges D92 if greater stability is required, e.g. for sideways transfer from a wheel-chair.

Stabilising buffers ensure that the seat is held securely in position on the toilet bowl and provide extra stability when subjected to sideways loads. The stabilising buffers can be adjusted to be in contact with the inside or outside of the bowl, depending on its shape. Hard-wearing, easy-to-clean fittings.

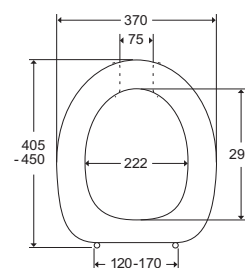

Many people find it difficult to sit down on and get up from standard height toilets. We are therefore able to supply Dania toilet seats in a raised version to help users to get up from and sit down on the toilet without assistance.

Stabilising buffers ensure that the seat is held securely in position on the toilet bowl and provide extra stability when subjected to sideways loads. The stabilising buffers can be adjusted to be in contact with the inside or outside of the bowl, depending on its shape. Hard-wearing, easy-to-clean fittings.

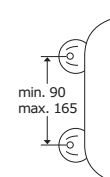
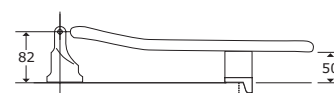

Going to the toilet



Toilet, wall-hung

R2091000 Wall-hung toilet, 540 mm

Material: Ceramics



Toilet brush

RT947 Wall-mounted toilet brush

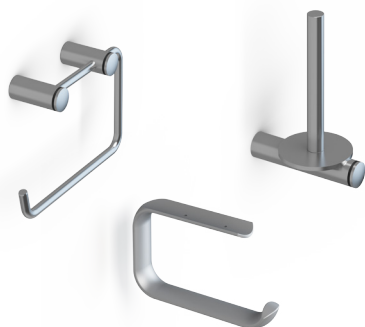

Toilet paper holders

RT945 Wall-mounted toilet paper holder

R9321 Toilet paper holder for fitting under the support arm

RT946 Spare paper holder



Flush button

R9342 Flush button for large and small flush

A wall-hung toilet can be mounted at whichever height is required, and facilitates the cleaning of the floor.

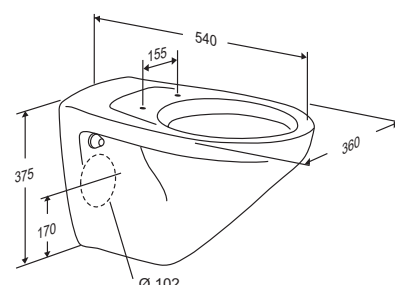

Toilet brush for wall mounting. Sleek and minimalist design that perfectly matches the other products in the series. A clear floor – everything in its place.

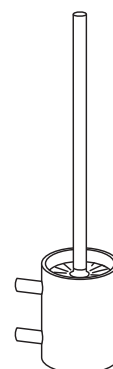

A paper holder mounted directly under the support arm ensures that the toilet paper is always within easy reach.

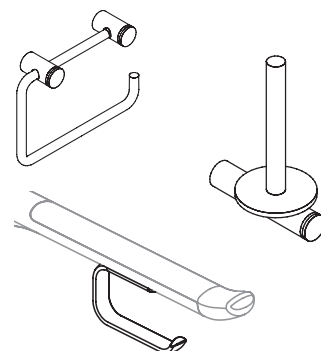

Push-button operation for remote control of flush function.

The flush button can be mounted directly underneath the support arm and functions with selected Geberit built-in cisterns.

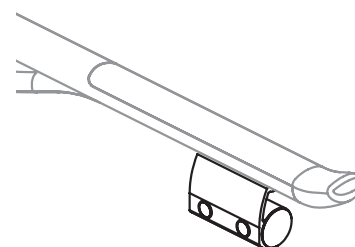

Taking a shower



Height-adjustable shower seats – Electrically operated

- R7470000** With backrest and armrests incl. wired hand control (white)
 - ◀ **R7470112** With backrest and armrests incl. wired hand control (anthracite grey)
- Materials: Aluminium, soft PUR foam with marine plywood core, plastic, two-component plastic.
- Test load: Seat: 150 kg. Armrest: 45 kg



Height-adjustable shower seats – Manual

- R7430112000** Manually adjusted, with backrest and armrests (white)
 - ◀ **R7430112112** Manually adjusted, with backrest and armrests (anthracite grey)
 - R7420112000** Manually adjusted, with backrest (white)
 - R7420112112** Manually adjusted, with backrest (anthracite grey)
- Materials: Aluminium, soft PUR foam with marine plywood core, plastic, two-component plastic.
- Test load: Seat: 150 kg. Armrest: 45 kg



Handrails

- RT102000** 600 mm (white)
 - ◀ **RT102112** 600 mm (anthracite grey)
 - RT103000** 800 mm (white)
 - RT103112** 800 mm (anthracite grey)
 - RT104000** 1000 mm (white)
 - RT104112** 1000 mm (anthracite grey)
- Materials: Powder-coated aluminium, plastic
- Test load: With spans up to 1000 mm: 210 kg



Shower head holder and shower head

- RT600000** Shower head holder for vertical handrail (white)
 - ◀ **RT600112** Shower head holder for vertical handrail (anthracite grey)
 - ◀ **RT611** Shower head, three spray modes (standard, soft, massage)
- VA-approved in Denmark.
- Materials: Powder-coated aluminium, plastic, aluminium



P. 32-35

Mounted at the recommended height, the height of the shower seat can be adjusted by 500 mm from 200 to 700 mm above floor level.

The shower seat is made from soft, non-slip materials which make bathing a pleasant and safe experience. Both the seat and the armrests can be folded up against the wall after use, creating space for standing users

The seat, backrest and armrests can be adjusted simultaneously thanks to the wired hand control or cordless remote control. The armrests can also be adjusted independently of the seat and backrest.

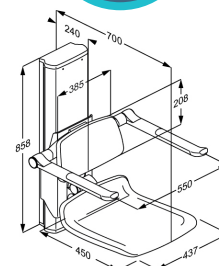

With the vertical wall track mounted at the recommended height, the height of the shower seat can be adjusted by 380 mm from 370 to 750 mm above floor level.

The shower seat is made from soft, non-slip materials which make bathing a pleasant and safe experience. Both the seat and the armrests can be folded up against the wall after use, creating space for standing users

The seat, backrest and armrests can be adjusted simultaneously thanks to a safe and easy click system. The armrests can also be adjusted independently of the seat and backrest.

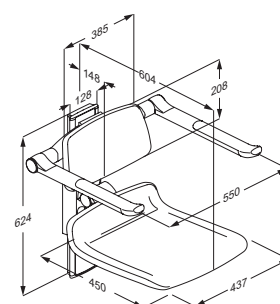

A handrail mounted by the shower provides support, a sense of security and increased independence. They can be placed either horizontally or vertically. A vertical handrail can double as a shower riser rail. The handrails are supplied in white or anthracite grey.

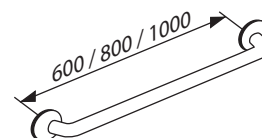

By mounting a shower head holder RT600 on the vertical handrail one may benefit from the support of the handrail in the shower corner and get the use of the one-hand operated shower head holder as well. The shape of the shower head holder and the locking system facilitate height adjustment – even for weak hands. Thanks to the click system, the angle of the hand shower – and thereby the stream of water – can easily be adjusted as desired.

Shower head: The curved shape of the handle and the weight balance between the head and handle make the shower head suitable for weak hands. An adjustment ring makes it easy to change the spray mode. The silicone spray jets are easy to keep free of limescale. A 2000 mm shower hose and swivel joints allow the shower head to be used over a large radius.

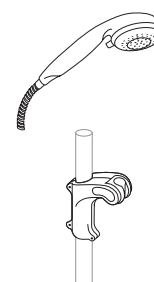

Taking a shower – in the small bathroom

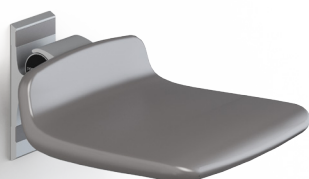

Fixed height shower seats

- R7310000** Shower seat 310 (white)
- ◀ **R7310112** Shower seat 310 (anthracite grey)
- R7408000** Shower seat 450 (white)
- R7408112** Shower seat 450 (anthracite grey)

Materials: Aluminium, soft PUR foam with marine plywood core, plastic, two-component plastic.
Test load: 150 kg.



Height-adjustable folding seats

- ◀ **R5520112000** Folding seat (white)
- R5520112112** Folding seat (anthracite grey)

Materials: Aluminium, thermoset plastic, plastic.
Test load: 135 kg.

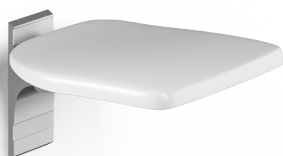

Fixed height folding seats

- ◀ **R5510000** Folding seat (white)
- R5510112** Folding seat (anthracite grey)

Materials: Aluminium, thermoset plastic, plastic.
Test load: 135 kg.



Handrails

- RT102000** 600 mm (white)
- ◀ **RT102112** 600 mm (anthracite grey)
- RT103000** 800 mm (white)
- RT103112** 800 mm (anthracite grey)
- RT104000** 1000 mm (white)
- RT104112** 1000 mm (anthracite grey)

Materials: Powder-coated aluminium, plastic
Test load: With spans up to 1000 mm: 210 kg

MOUNTING
TEST LOAD

P. 32-35

Mounted at the recommended height, the height of the shower seat will be 400 mm above floor level.

The shower seat is made from soft, non-slip materials which make bathing a pleasant and safe experience. The seat can be folded up against the wall after use, creating space for standing users.

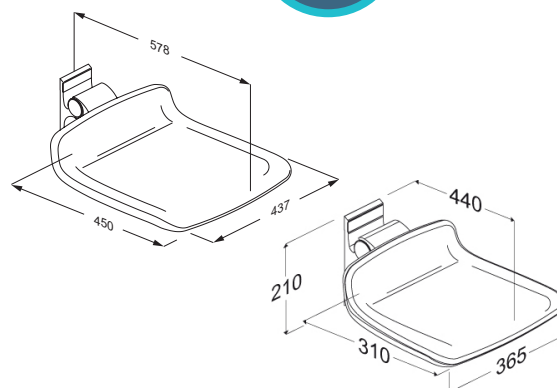

With the vertical wall track mounted at the recommended height, the height of the folding seat can be adjusted by 240 mm from 380 - 620 mm above floor level.

The folding seat is ideal when extra seating is required, but space is limited. This is often the case in places where it might be necessary to take a rest, e.g. in the kitchen, lift, corridor or when dressing and undressing in the bathroom.

Recommendation: only suitable for persons with good independent living capability.

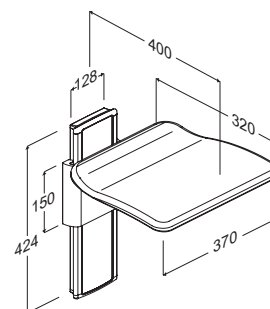

Mounted at the recommended height, the height of the folding seat will be 440 mm above floor level.

The folding seat is ideal when extra seating is required, but space is limited. This is often the case in places where it might be necessary to take a rest, e.g. in the kitchen, lift, corridor or when dressing and undressing in the bathroom.

Recommendation: only suitable for persons with good independent living capability.

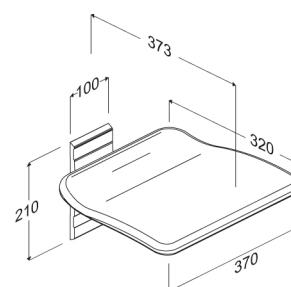

A handrail mounted by the shower provides support, a sense of security and increased independence. They can be placed either horizontally or vertically. A vertical handrail can double as a shower riser rail. The handrails are supplied in white or anthracite grey.

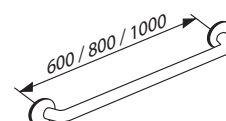

Mounting

Mounting – recommended heights

PLUS – wash basin bracket,
electric

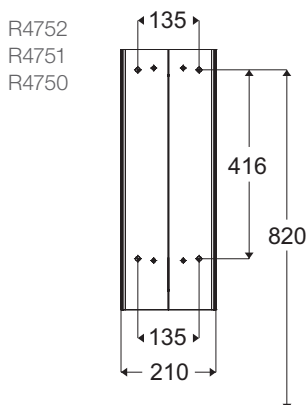

PLUS – wash basin bracket,
gas

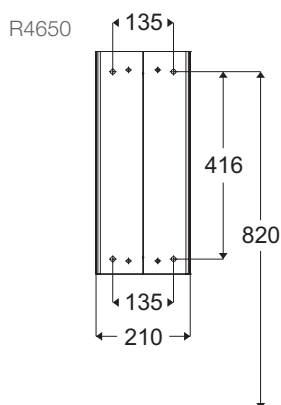

Shower seat,
electric

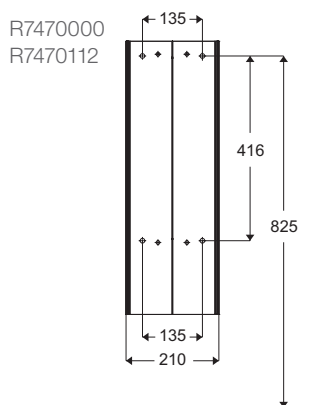

Shower seat,
on vertical wall track

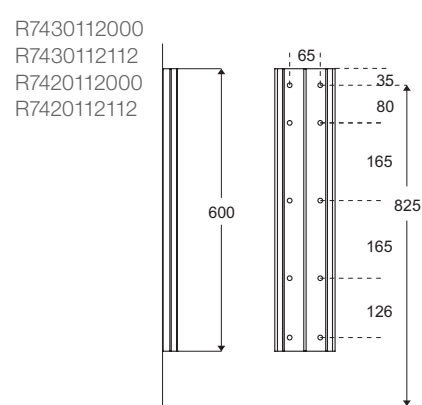

SELECT – wash basin bracket,
electric

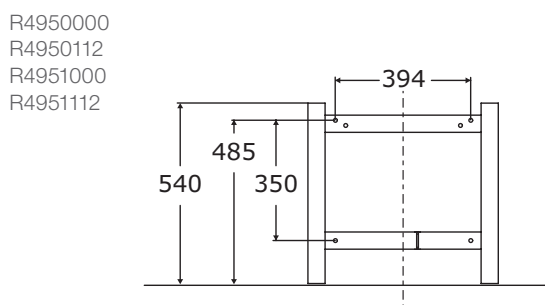

Shower seat,
fixed

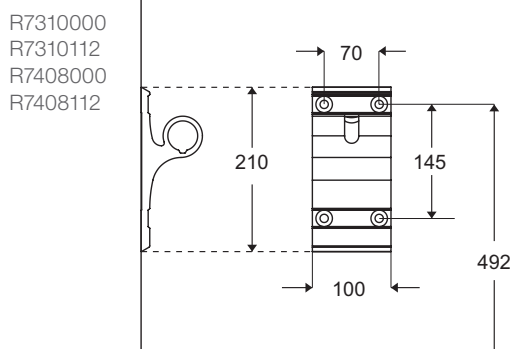

Support arms,
on vertical wall track

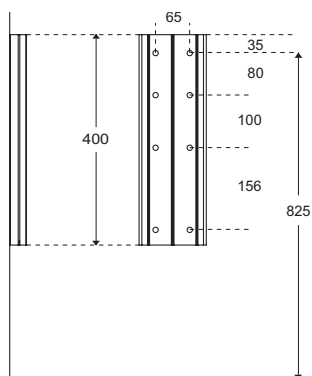

R3160112000
R3160112112

Support arms,
fixed

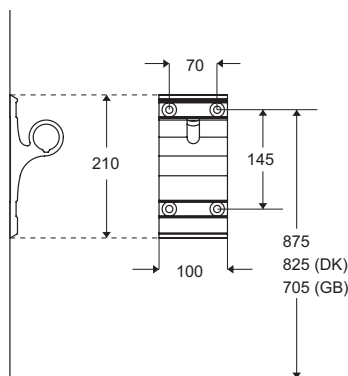

R3060000
R3060112
R3070000
R3070112

Folding seat,
on vertical wall track

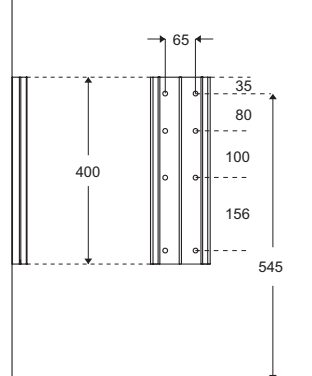

R5520112000
R5520112112

Folding seat,
fixed

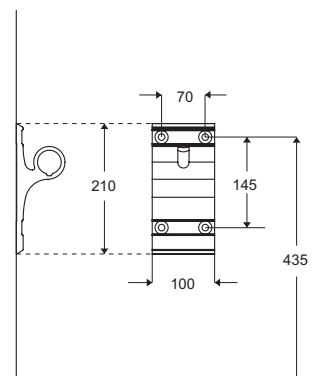

R5510000
R5510112

Water and electric installations

R2061

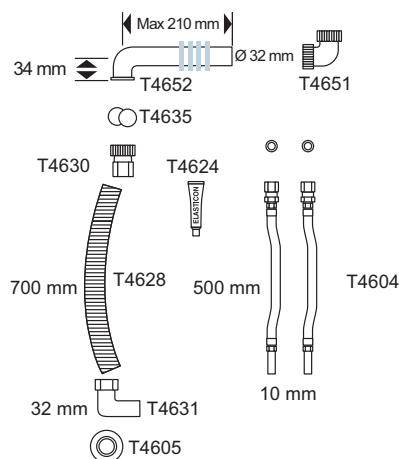

R2062

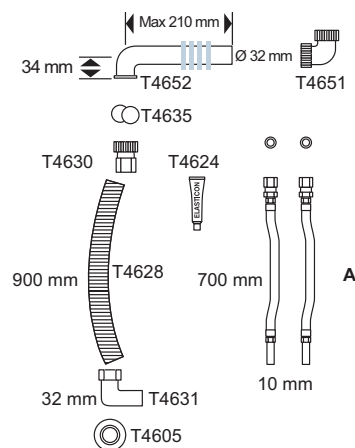

Height-adjustable wash basin brackets require flexible feed and waste systems. It is important that the plumbing installations are correctly positioned. Detailed mounting instructions are, of course, supplied with the individual products, but they can also be requested separately, e.g. for planning purposes.

Flexible feed and waste system

R2061 For PLUS wash basin bracket
Feed hoses: 500 mm, waste hoses: 700 mm

R2071 For SELECT wash basin bracket
Feed hoses: 500 mm, waste hoses: 700 mm

Feed and waste hoses are VA-approved in Denmark.

Flexible feed and waste systems can be supplemented with:

Water trap: R2058

Air relief kit: R2059

Pressalit Care recommends that feed and waste wall connections are at 90° angles, pointing downwards.

Mounting of feed and waste systems

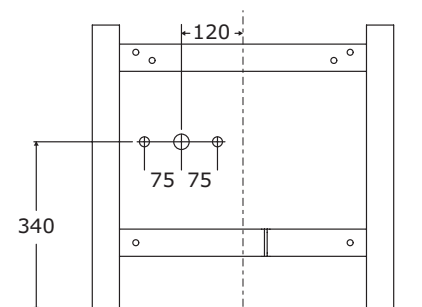

R4950
R4951

Mounting of electric installations

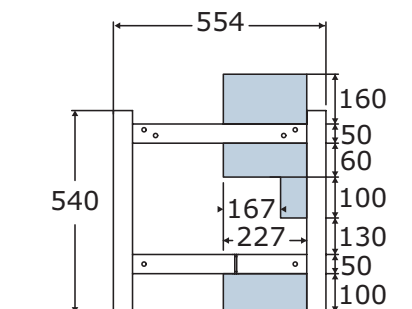

R4950
R4951

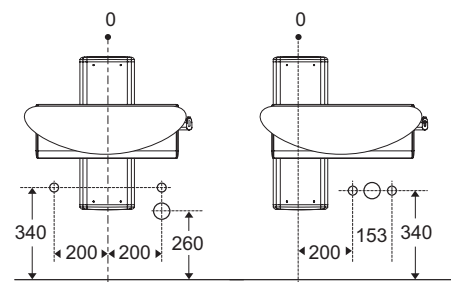

Methods of testing

At Pressalit Care we test our products so we can be completely sure that they can withstand even extreme real-life conditions. We push the products to the very limit to identify any weaknesses by subjecting them to rigorous tests. Therefore, we can guarantee the values we provide. The products comply with the requirements in BS/EN 12182:2012.

For example, the illustration below shows our test method for a support arm. The load which the product can withstand increases the further back on the support arm one tests it. However, we have decided to state the lowest values, which means that the lifespan of the product is even longer in use, as the load is often applied closer to the wall.

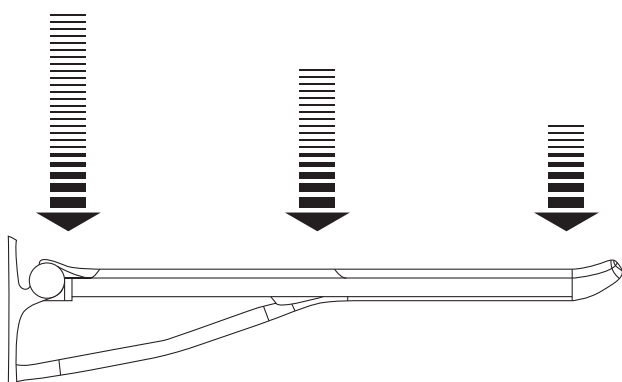

All tests have been conducted by mounting the products on a solid wall, which is what Pressalit Care recommends. The lifespan of the product is not affected in any way by the wall type. However, the overall solution will inevitably be influenced by the condition and material of the wall, so reinforcement should always be used if the wall is not stable.



Static test

We also conduct a static test on our products, and we therefore know exactly how many kilograms each product can carry for 1 minute. The statistical test is also carried out on the weakest part of each product.



Safety Factor

According to the European standard for technical aids for the disabled (BS/EN 12182:2012) the manufacturer must advise of the maximum load of a product. The maximum load is less than the product has actually been tested to carry, since it must include a safety factor of 1.5.

Maximum load x Safety factor = Test load

The weight limits given in this catalogue are the Tested load.



Lateral test

In addition to the above testing methods, we subject our support arms and armrests to a lateral test to find out whether they can withstand being used by, e.g., a wheelchair user when moving himself. The lateral test involves pressing the product 10,000 times at a 45° angle for 2 seconds at a time.

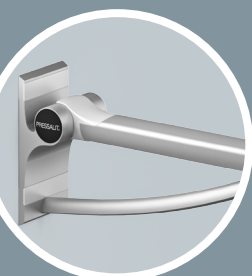

Support arms

R3060 - R3585 + RF060 - RF585

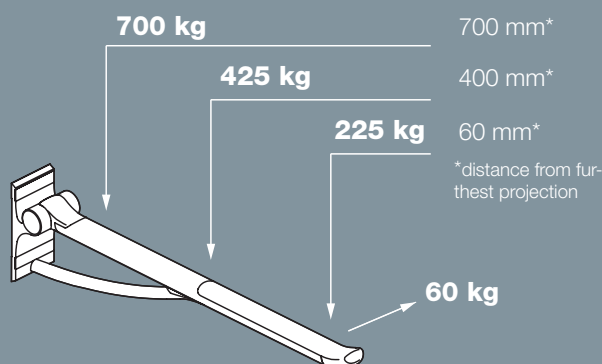
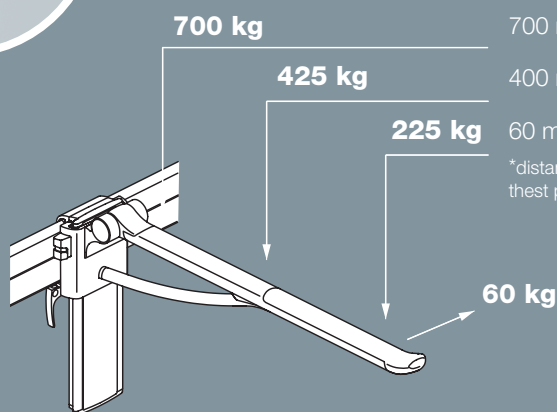



Shower Seat

R7470, R7430, R7420,
R7408 + R7310

Electrically operated shower seats
have a maximum load of 150 kg
during height adjustment.

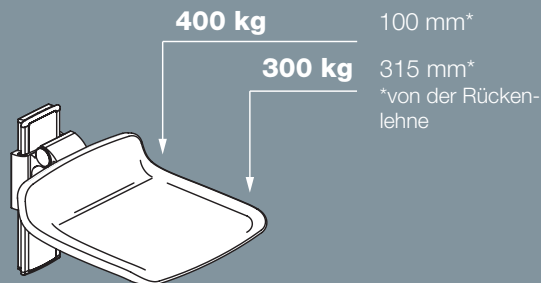
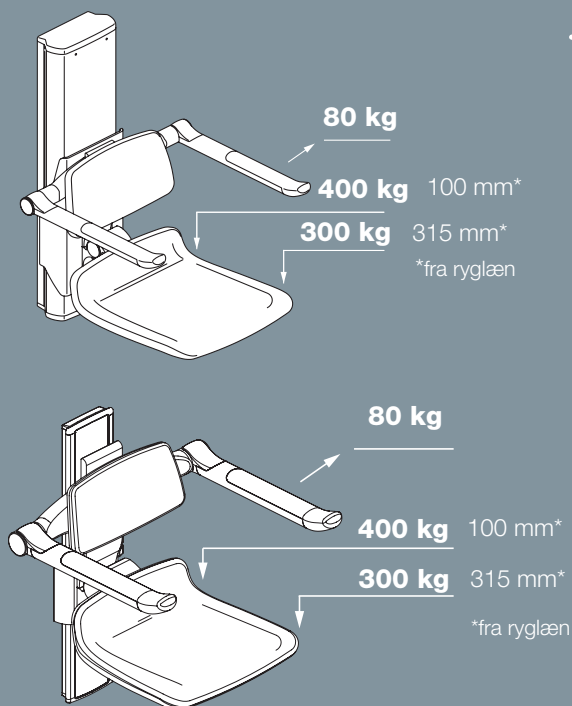

Klapsæder

R5510 - R5530

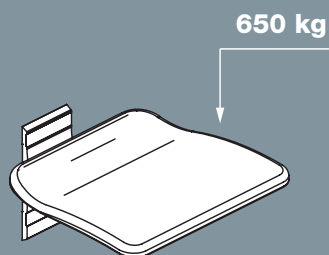
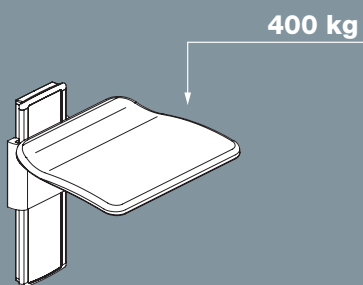
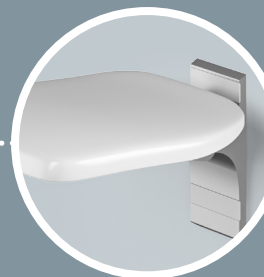

Vaskophæng

R4750 - R 4752 + R4650



Vaske med elektrisk løft kan max.
klare 100 kg belastning ved højde-
regulering.

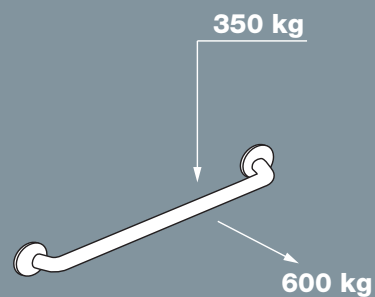
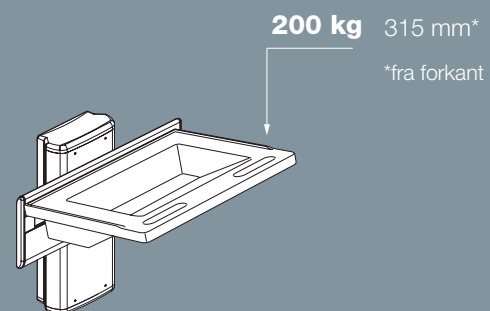

RT102 - RT104

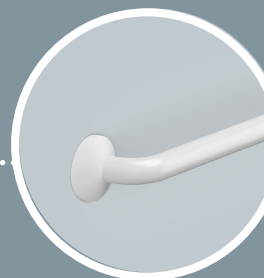

PRESSALIT[®] care

Reduced functionality need not limit a person's development. For more than 35 years, the keep living philosophy has been a guiding principle for Pressalit Care's development of flexible kitchen and bathroom solutions for people with disabilities.

Thanks to its research-based knowledge, Pressalit Care is a market leader within specialist kitchen and bathroom solutions and today provides consultancy to customers worldwide.

An underlying respect for the individual and his or her possibilities is also reflected in the company's relationship to society at large and the local community. At Pressalit, Corporate Social Responsibility (CSR) is deeply rooted in the company's strategy and values and guides all parts of the organisation

Pressalit Care's head office is located in Denmark.

www.pressalit.com

Pressalit A/S

Pressalitvej 1
8680 Ry
Denmark
Tel.: +45 8788 8788
Fax: +45 8788 8789
E-mail: pressalit@pressalit.com

UK Sales - Pressalit Care plc

100 Longwater Avenue
Green Park
Reading
RG2 6GP
United Kingdom
Tel.: +44 844 880 6950
Fax: +44 844 880 6951
E-mail: uk@pressalit.com

International Sales Department

Pressalitvej 1
8680 Ry
Denmark
Tel.: +45 8788 8777
Fax: +45 8788 8669
E-mail: sales@pressalit.com

